

- NOTES:
 1. DIMS IN INCHES
 2. QTY:1
 3. MTL: 20 GA SHEET STEEL
 4. BREAK ALL EGDES

FOLDED VIEW

TOLERANCE UNLESS NOTED			TITLE:		
OPERATION	PLACES IN DIMENSION			Ball Hopper Top Attachment	
	0.0	0.00	0.000	DRAWN	
MACHINING				DESIGNED	
SHEETMETAL (SHEAR, BEND)	±0.1	±0.060	±0.030	SIZE	DWG. NO.
WELDING	±0.1	±0.060		A	EML2322L-113
ANGULAR DIMS	±5	±2		SCALE: 3:2	SHEET 1 OF 2
					REV
					B

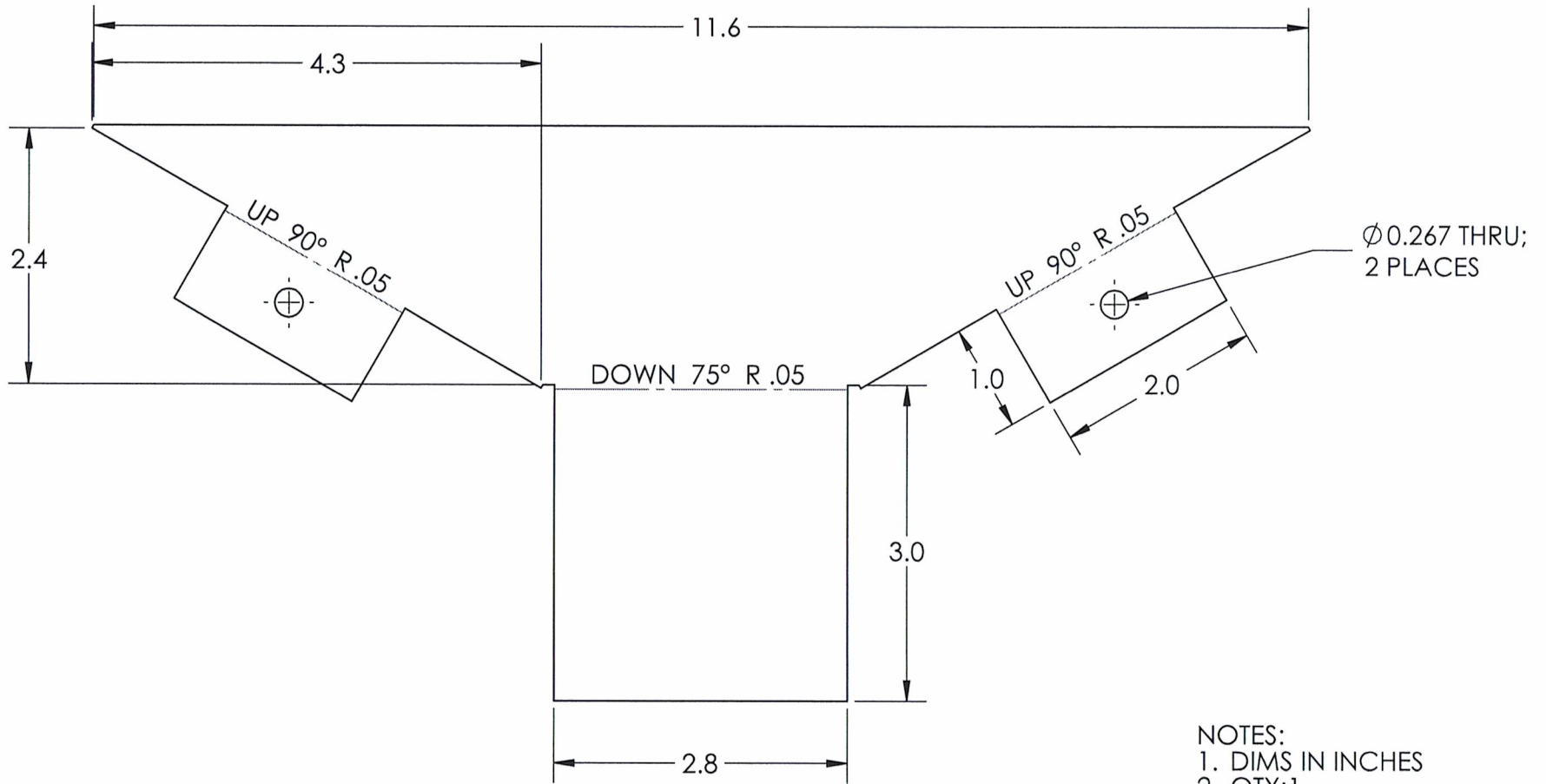

- NOTES:
 1. DIMS IN INCHES
 2. QTY:1
 3. MTL: 20 GA SHEET STEEL
 4. BREAK ALL EDGES

UNFOLDED VIEW

TOLERANCE UNLESS NOTED			TITLE:			
OPERATION	PLACES IN DIMENSION			Ball Hopper Top Attachment		
	0.0	0.00	0.000	DRAWN		
MACHINING				DESIGNED		
SHEETMETAL (SHEAR, BEND)	±0.1	±0.060	±0.030	SIZE	DWG. NO.	REV
WELDING	±0.1	±0.060		A	EML2322L-113	B
ANGULAR DIMS	±5	±2		SCALE: 2:3		SHEET 2 OF 2